

SMITH CONCEPT PRO

MULTIGYM G7

SMITH CONCEPT PRO

Installation Instructions

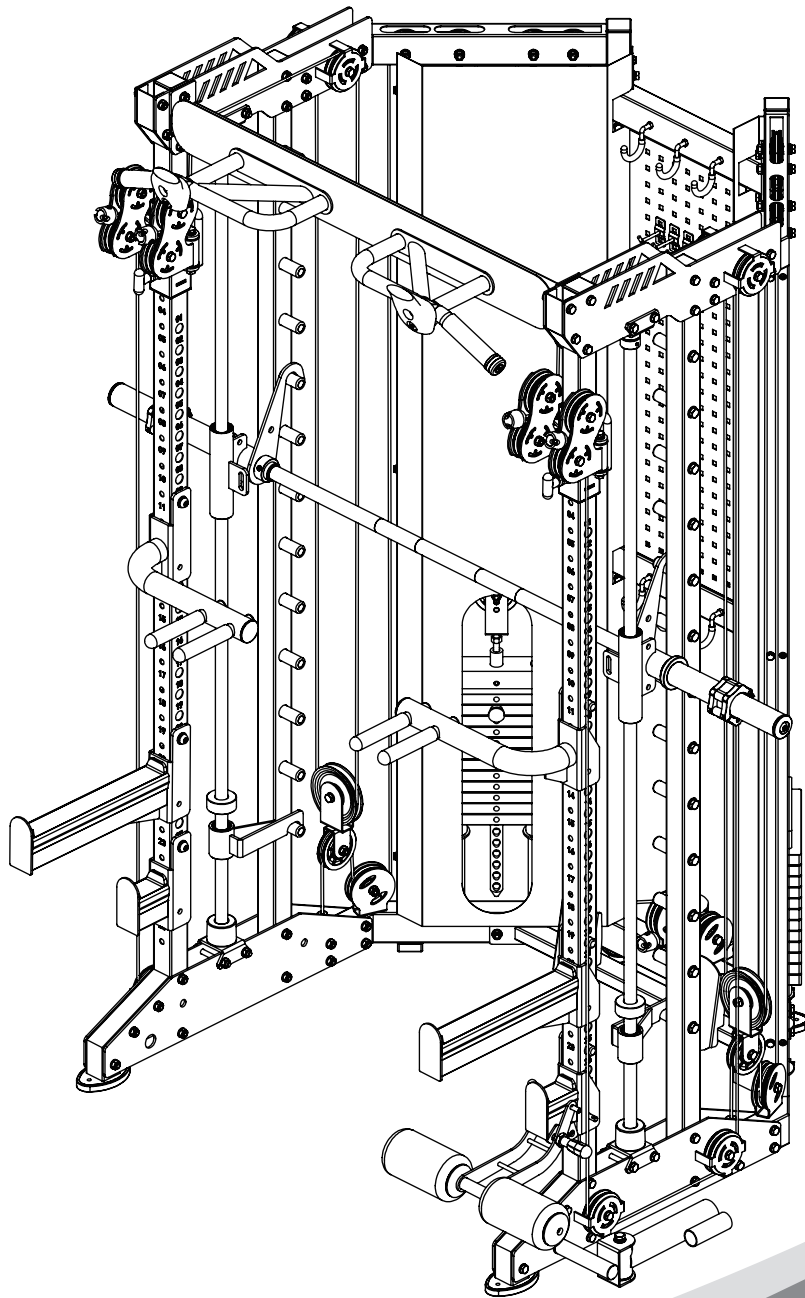

TABLE OF CONTENTS

Parts List	3~5
Assembly Step 1	6
Assembly Step 2	7
Assembly Step 3	8
Assembly Step 4	9
Assembly Step 5	10
Assembly Step 6	11
Assembly Step 7	12
Assembly Step 8	13
Assembly Step 9	14
Assembly Step 10	15
Assembly Step 11	16
Assembly Step 12	17
Assembly Step 13	18
Assembly Step 14	19
Assembly Step 15	20
Assembly Step 16	21
Accessory	22

Measuring For Bolt Length



PARTS LIST

NO.	DESCRIPTION	NOTE	QTY
1	Rear Lower Connection Frame	Assembly Part	1
2	Right Frame	Assembly Part	1
3	Left Frame	Assembly Part	1
4	Leg Press Frame	Welding Part	1
5	Big Flat Washer	$\phi 30 * \phi 10 * 3$	11
6	Hexagon Bolt	M10×70	20
7	Lock Nut	M10	72
8	Flat Washer	$\phi 10$	164
9	Upper Connection Frame	Assembly Part	2
10	Hexagon Bolt	M10×25	17
11	Spring Gasket	$\phi 10$	16
12	Lower Fixing Plate Right	Welding Part	1
13	Lower Fixing Plate	T5	2
14	Front Supporting Frame	Assembly Part	2
15	Hexagon Bolt	M10×75	38
16	Lower Fixing Plate Left	Welding Part	1
17	Upright	Assembly Part	2
18	Front Stainless Steel Tube	Assembly Part	2
19	Sliding Tube	Assembly Part	2
20	Upper Fixing Plate Right	Welding Part	2
21	Upper Fixing Plate Left	Welding Part	2
22	Decorative Plate	T2	2
23	Chin Up Bar	Assembly Part	1
24	Hexagon Bolt	M10×80	4
25	Shock Pad	$\phi 60 * \phi 27 * 42$	4
26	Magnetic Pin	$\phi 10 * 100$	2
27	Weight Pin	10×60	2
28	Hexagon Bolt	M10×45	8
29	Selector Rod	$\phi 25$	2
30	Weight	60kg	2
31	Guide Rod	Assembly Part	4
32	Weight Support Frame	Welding Part	4
33	Weight Pulley	Assembly Part	2
34	Wire	Assembly Part	2

PARTS LIST

NO.	DESCRIPTION	NOTE	QTY
35	Pulley	φ92	14
36	Pulley Bracket	Assembly Part	2
37	Hexagon Bolt	M10×60	8
38	Wire	Assembly Part	2
39	Bushing	φ20×φ16×φ10.5×15	20
40	Pulley	φ75	10
41	Pulley Cover	T3	2
42	Headless Hexagon Socket Bolt	M8*10	2
43	Guide Rod Upper Base	Welding Part	2
44	Hexagon Bolt	M10×90	8
45	Guide Rod Lower Base	Welding Part	2
46	Guide Rod	φ25*1878	2
47	Lock Sleeve	φ40*φ25.5*35	2
48	Sliding Sleeve	Assembly Part	2
49	Rubber Shock Pad	φ60×φ26×25	2
51	Safety Hook Right	Assembly Part	1
52	Rubber Shock Pad	φ60×φ26×45	2
53	Barbell Bar	Assembly Part	1
54	Safety Hook Left	Assembly Part	1
55	Flat Washer	φ12	2
56	Spring Gasket	φ12	2
57	Hexagon Socket Button Head Screw	M12×40	2
58	Barbell Clamp	φ85Xφ50XH49	2
59	Barbell Bar Sleeve	Assembly Part	2
60	Shield	T2	1
61	Hook	Assembly Part	6
62	Flat Washer	φ8	16
63	Hexagon Bolt	M8×25	16
64	Hook	50mm	4
65	Weight Plate Cover Left	T1	1
66	Weight Plate Cover Right	T1	1
67	Dip Handle Left	Assembly Part	1
68	Bushing	φ33×φ29×φ20×18	2
69	Core Trainer	Assembly Part	1

PARTS LIST

NO.	DESCRIPTION	NOTE	QTY
70	Leg Press	Assembly Part	1
71	Safety Spotter Right	Assembly Part	1
72	Dip Handle Right	Assembly Part	1
73	Safety Spotter Left	Assembly Part	1
74	J Hook Right	Assembly Part	1
75	J Hook Left	Assembly Part	1
76	T-shaped Pin	φ10×85	1
77	Lat Pull Down Bar	Assembly Part	1
78	Low Pull Handle	Assembly Part	1
79	Dual Cable Connector	Assembly Part	3
80	Straight Bar	Assembly Part	1
81	Extension Chain+ Carabiner	Assembly Part	2
82	Carabiner	Standard Part	5
83	Nylon Handle	Universal Part	2

ASSEMBLY STEP 1

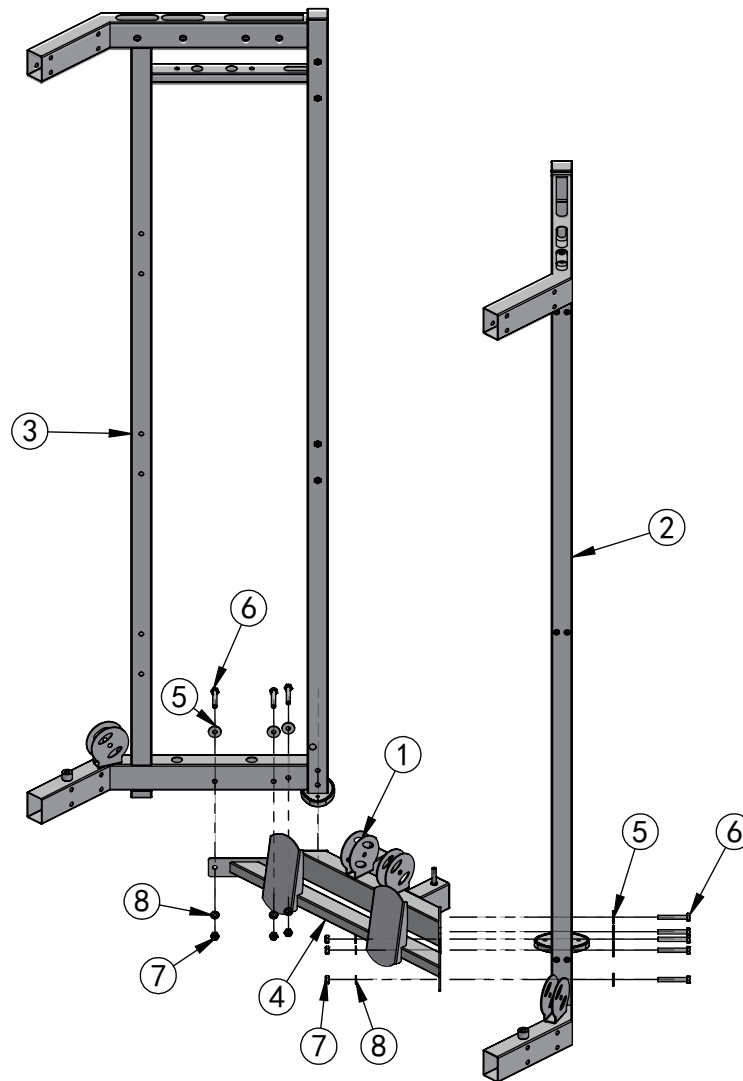

NO.	DESCRIPTION	NOTE	QTY
1	Rear Lower Connection Frame	Assembly Part	1
2	Right Frame	Assembly Part	1
3	Left Frame	Assembly Part	1
4	Leg Press Frame	Welding Part	1
5	Big Flat Washer	$\phi 30 * \phi 10 * 3$	10
6	Hexagon Bolt	M10×70	10
7	Lock Nut	M10	6
8	Flat Washer	$\phi 10$	6

ASSEMBLY STEP 2

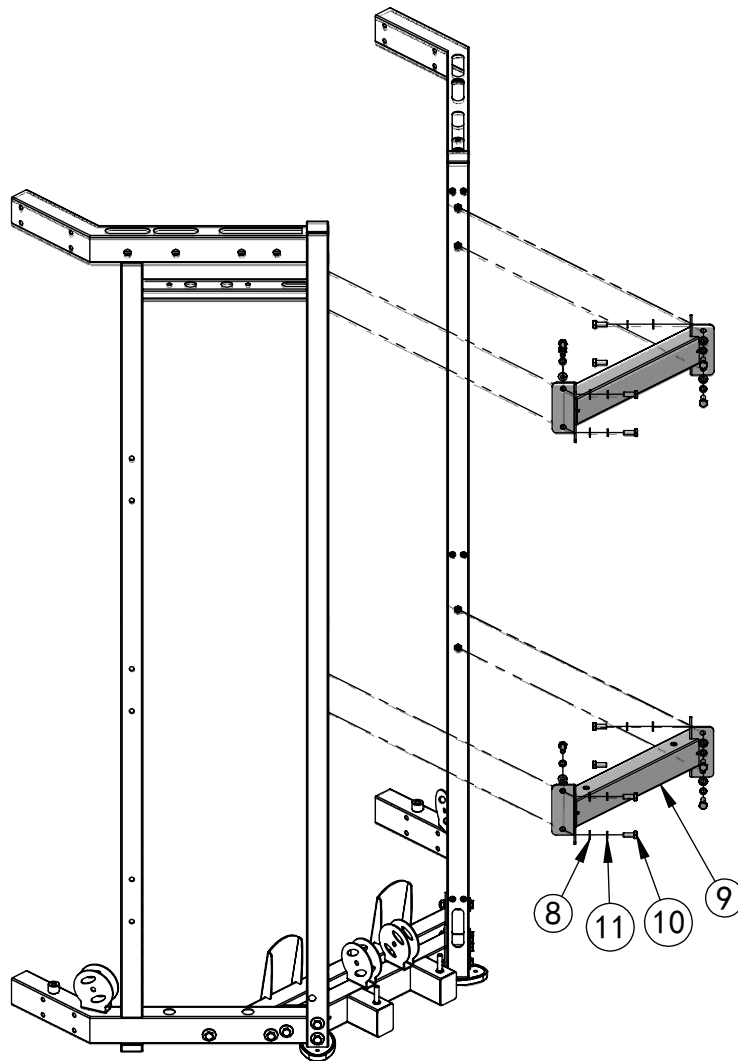

NO.	DESCRIPTION	NOTE	QTY
8	Flat Washer	$\phi 10$	16
9	Upper Connection Frame	Assembly Part	2
10	Hexagon Bolt	M10×25	16
11	Spring Gasket	$\phi 10$	16

ASSEMBLY STEP 3

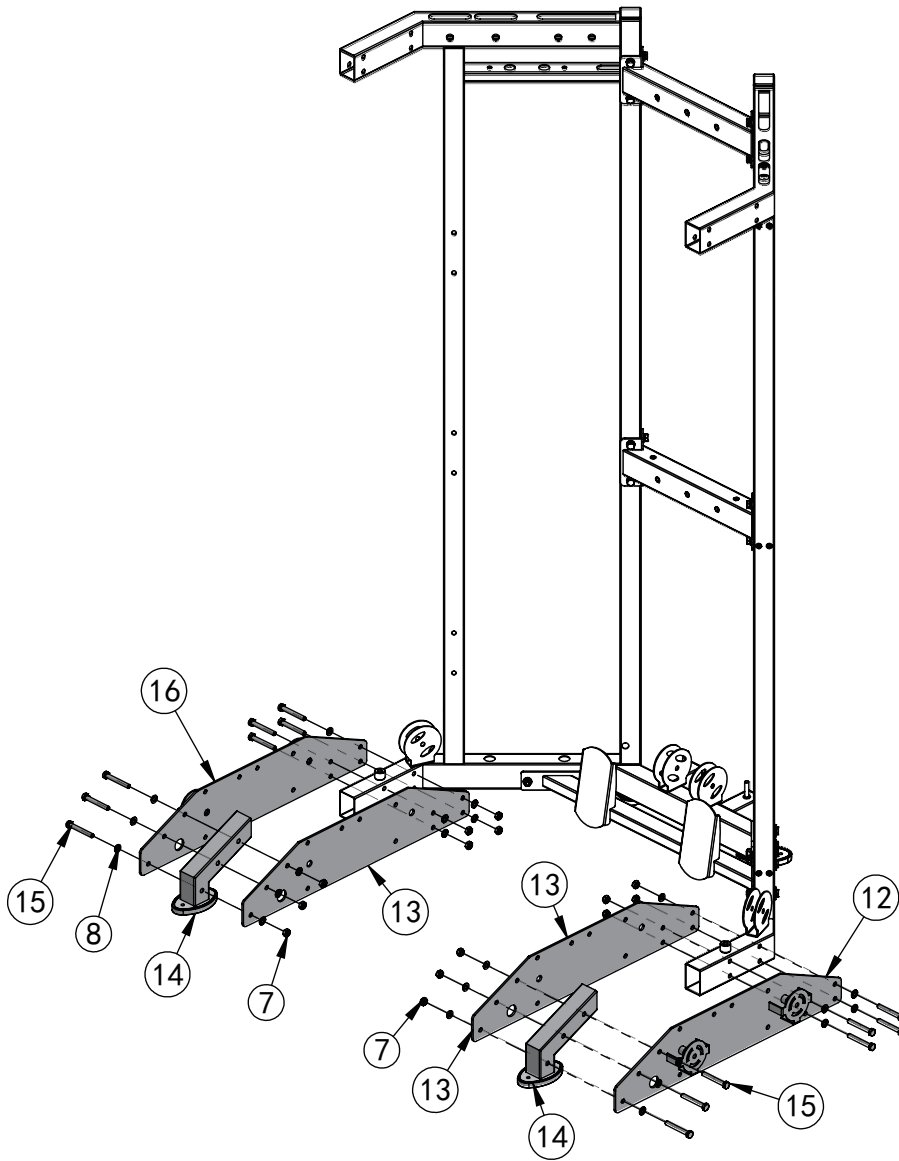

NO.	DESCRIPTION	NOTE	QTY
7	Lock Nut	M10	14
8	Flat Washer	$\phi 10$	28
12	Lower Fixing Plate Right	Welding Part	1
13	Lower Fixing Plate	T5	2
14	Front Supporting Frame	Assembly Part	2
15	Hexagon Bolt	M10×75	14
16	Lower Fixing Plate Left	Welding Part	1

ASSEMBLY STEP 4

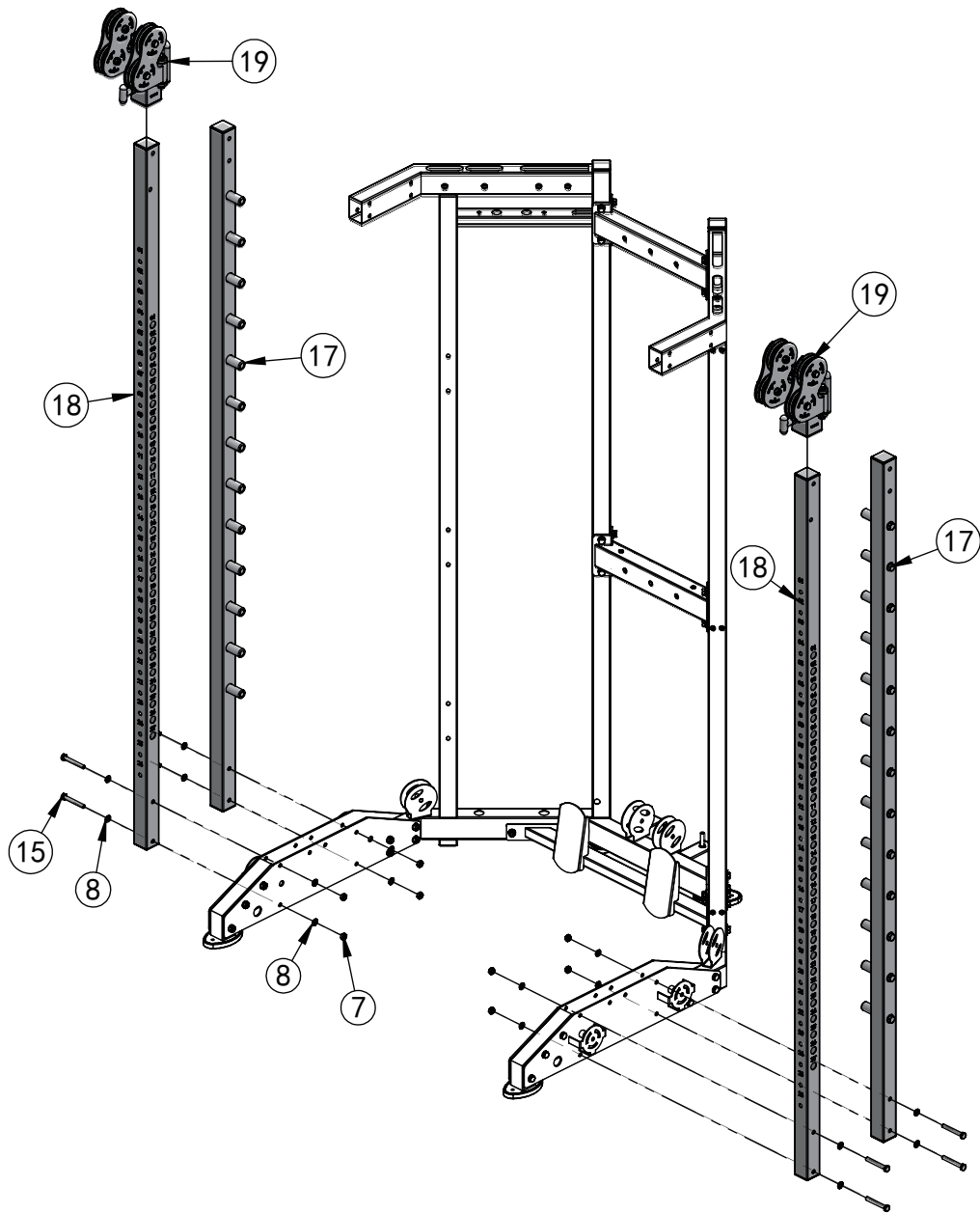

NO.	DESCRIPTION	NOTE	QTY
7	Lock Nut	M10	8
8	Flat Washer	φ10	16
15	Hexagon Bolt	M10×75	8
17	Upright	Assembly Part	2
18	Front Stainless Steel Tube	Assembly Part	2
19	Sliding Tube	Assembly Part	2

ASSEMBLY STEP 5

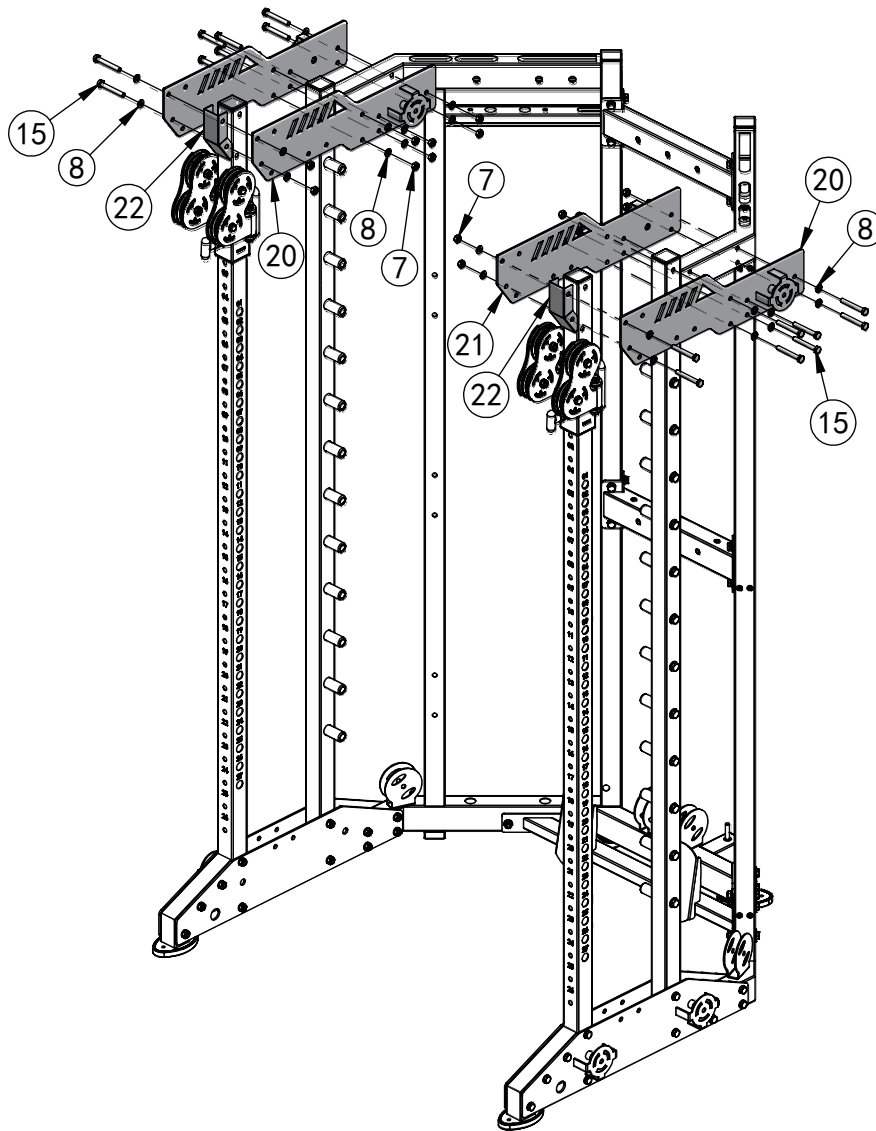

NO.	DESCRIPTION	NOTE	QTY
7	Lock Nut	M10	16
8	Flat Washer	φ10	32
15	Hexagon Bolt	M10×75	16
20	Upper Fixing Plate Right	Welding Part	2
21	Upper Fixing Plate Left	Welding Part	2
22	Decorative Plate	T2	2

ASSEMBLY STEP 6

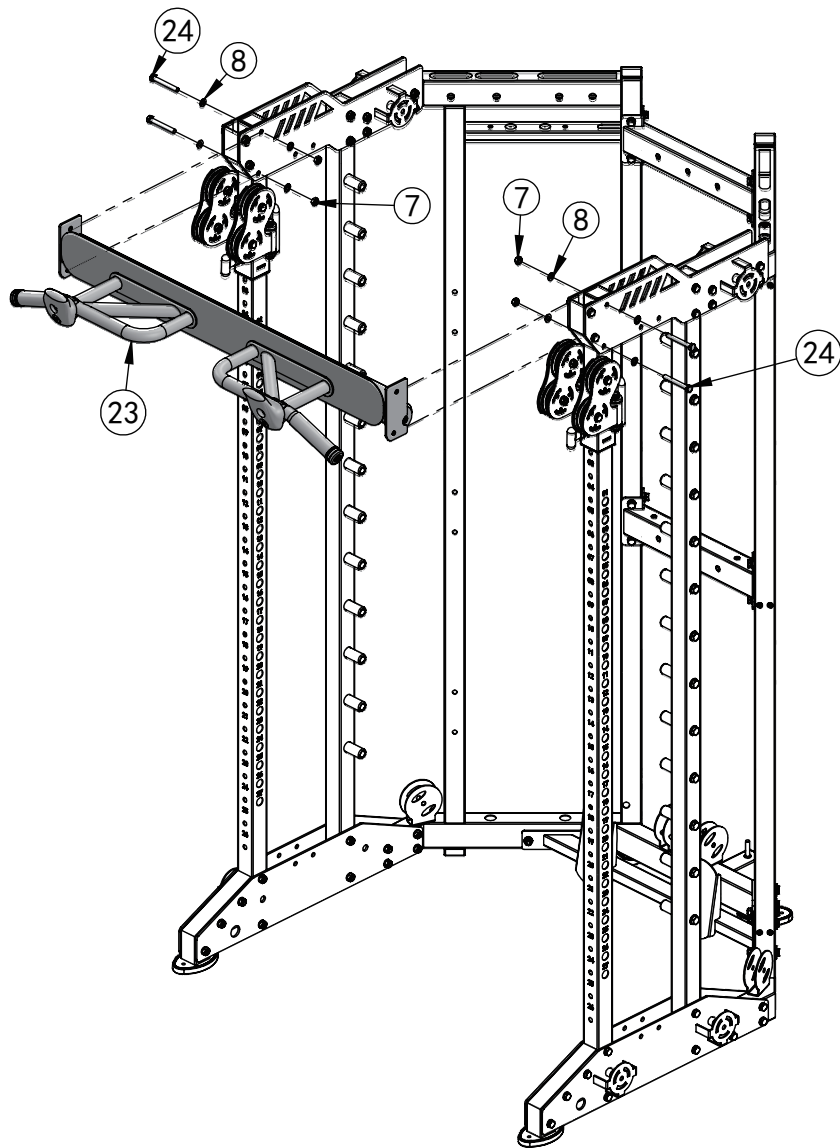

NO.	DESCRIPTION	NOTE	QTY
7	Lock Nut	M10	4
8	Flat Washer	φ10	8
23	Chin Up Bar	Assembly Part	1
24	Hexagon Bolt	M10×80	4

ASSEMBLY STEP 7

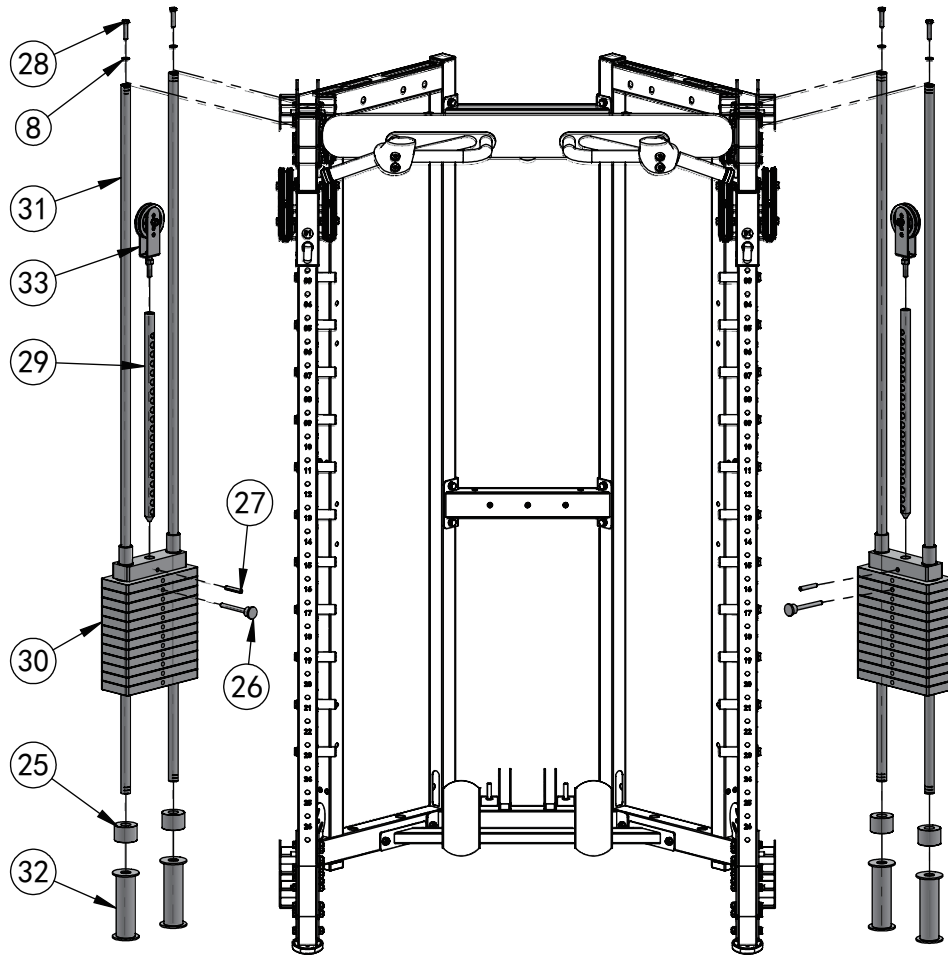

NO.	DESCRIPTION	NOTE	QTY
8	Flat Washer	φ10	4
25	Shock Pad	φ60×φ27×42	4
26	Magnetic Pin	φ10×100	2
27	Weight Pin	10×60	2
28	Hexagon Bolt	M10×45	4
29	Selector Rod	φ25	2
30	Weight	60kg	2
31	Guide Rod	Assembly Part	4
32	Weight Support Frame	Welding Part	4
33	Weight Pulley	Assembly Part	2

ASSEMBLY STEP 8

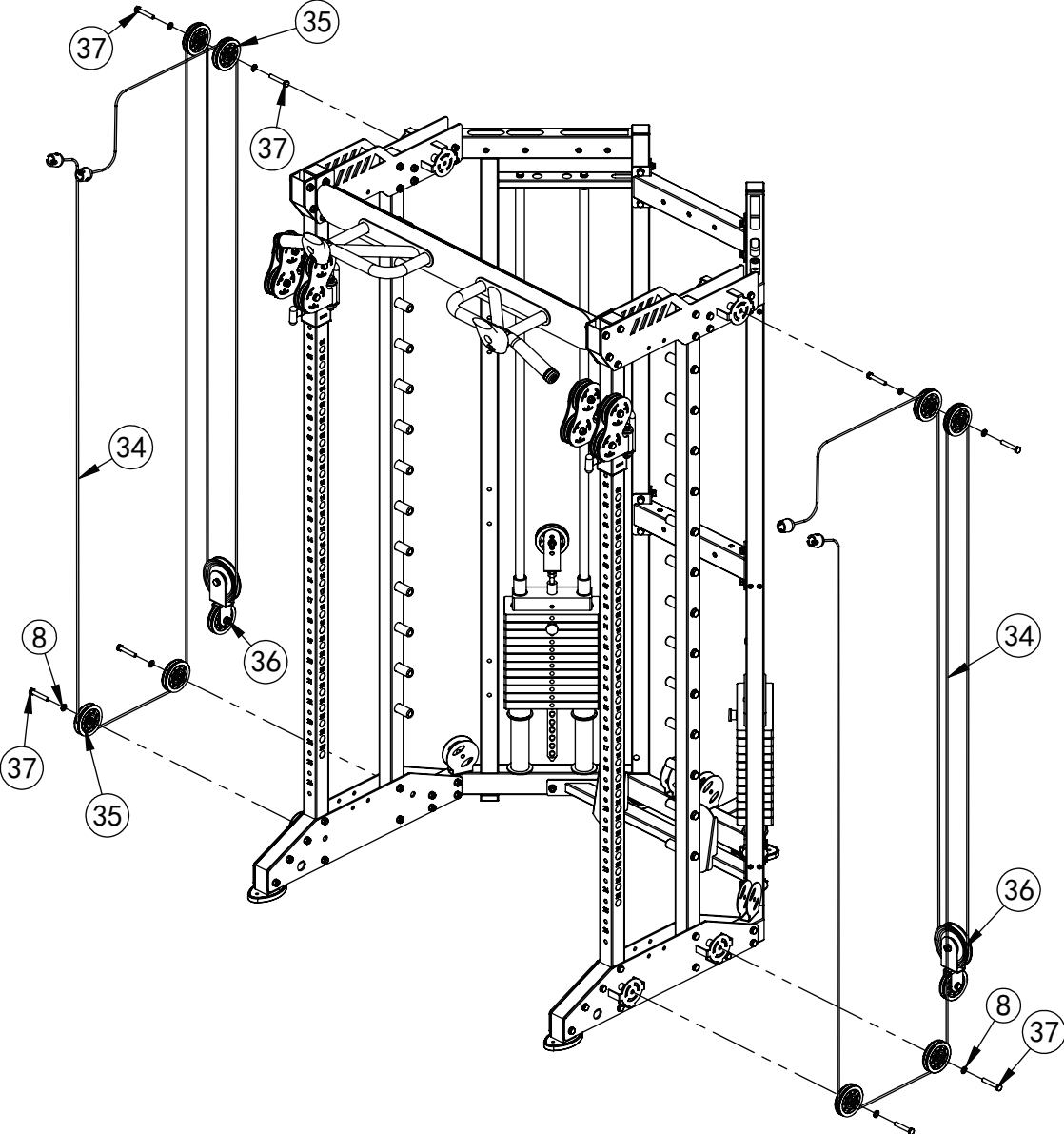

NO.	DESCRIPTION	NOTE	QTY
8	Flat Washer	φ10	8
34	Wire	Assembly Part	2
35	Pulley	φ92	8
36	Pulley Bracket	Assembly Part	2
37	Hexagon Bolt	M10×60	8

ASSEMBLY STEP 9

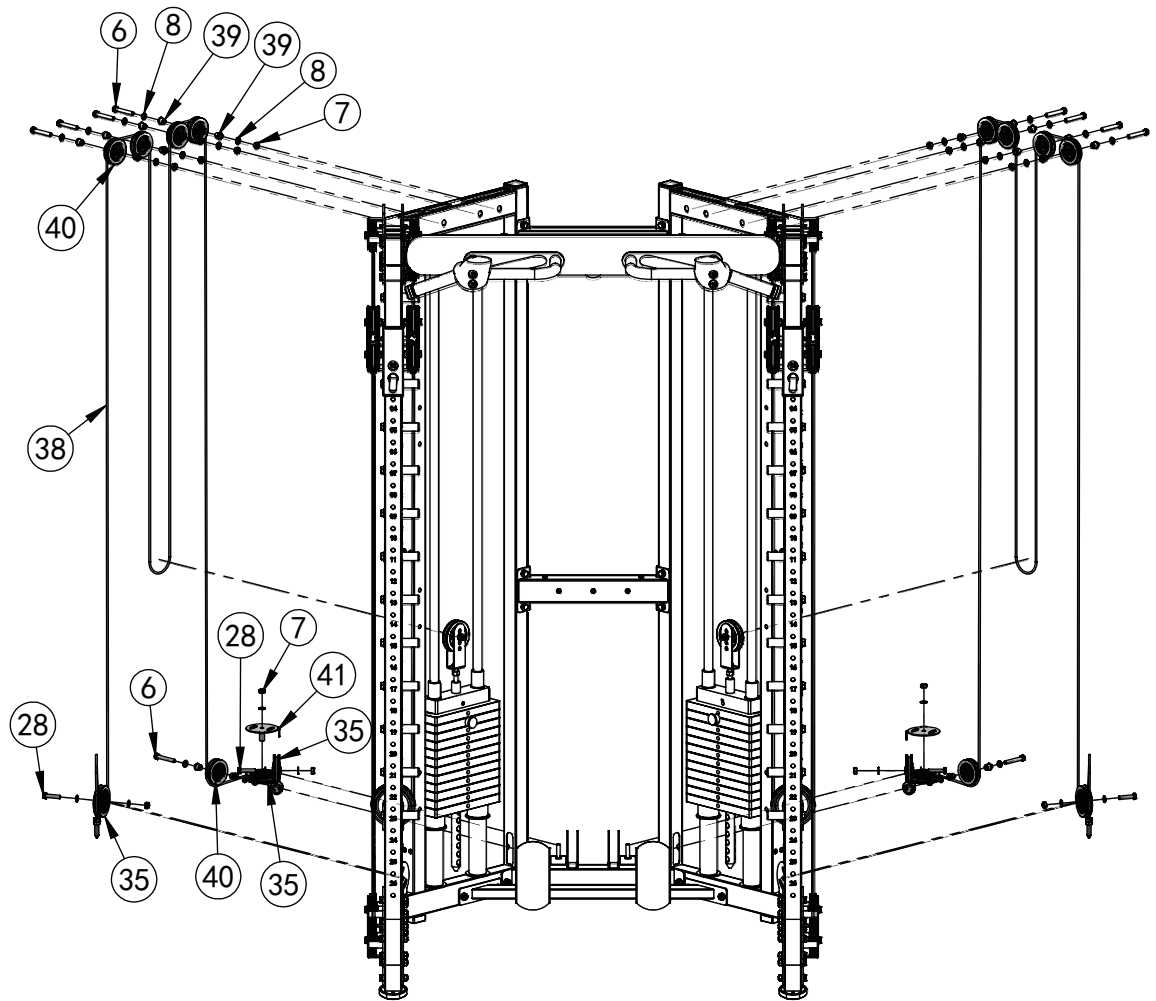

NO.	DESCRIPTION	NOTE	QTY
6	Hexagon Bolt	M10×70	10
7	Lock Nut	M10	16
8	Flat Washer	φ10	30
28	Hexagon Bolt	M10×45	4
35	Pulley	φ92	6
38	Wire	Assembly Part	2
39	Bushing	φ20×φ16×φ10.5×15	20
40	Pulley	φ75	10
41	Pulley Cover	T3	2

ASSEMBLY STEP 10

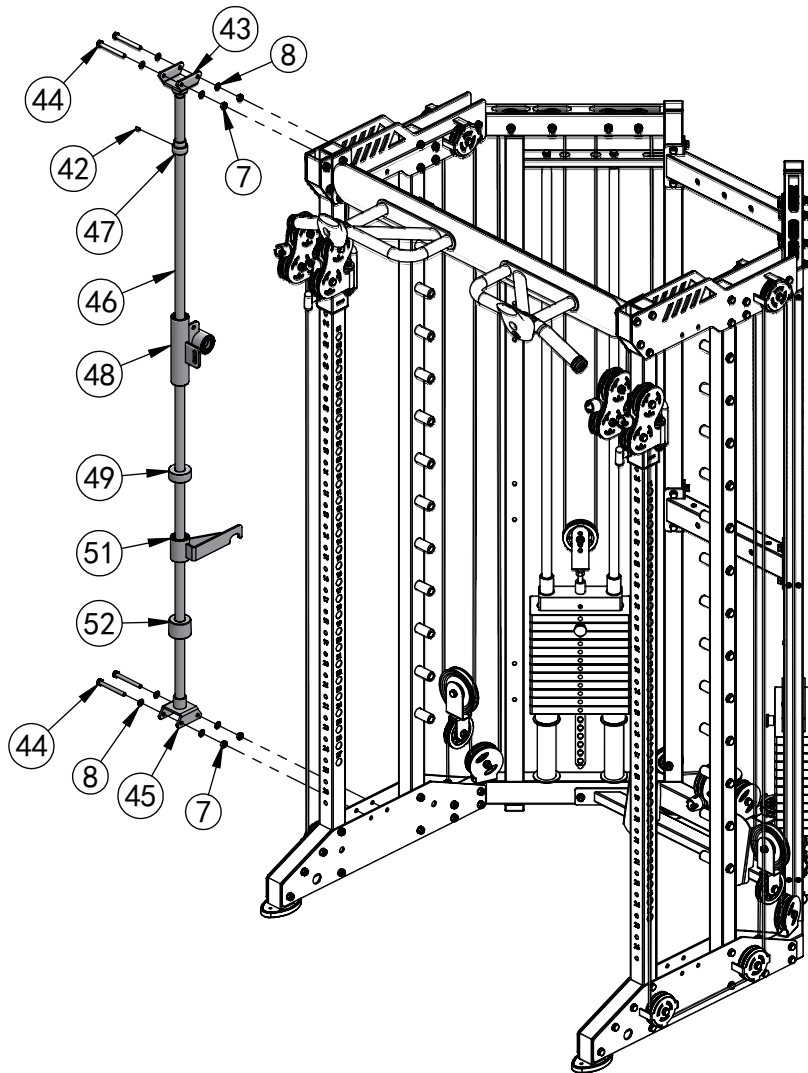

NO.	DESCRIPTION	NOTE	QTY
7	Lock Nut	M10	4
8	Flat Washer	φ10	8
42	Headless Hexagon Socket Bolt	M8*10	1
43	Guide Rod Upper Base	Welding Part	1
44	Hexagon Bolt	M10×90	4
45	Guide Rod Lower Base	Welding Part	1
46	Guide Rod	φ25*1878	1
47	Lock Sleeve	φ40*φ25.5*35	1
48	Sliding Sleeve	Assembly Part	1
49	Rubber Shock Pad	φ60×φ26×25	1
51	Safety Hook Right	Assembly Part	1
52	Rubber Shock Pad	φ60×φ26×45	1

ASSEMBLY STEP 11

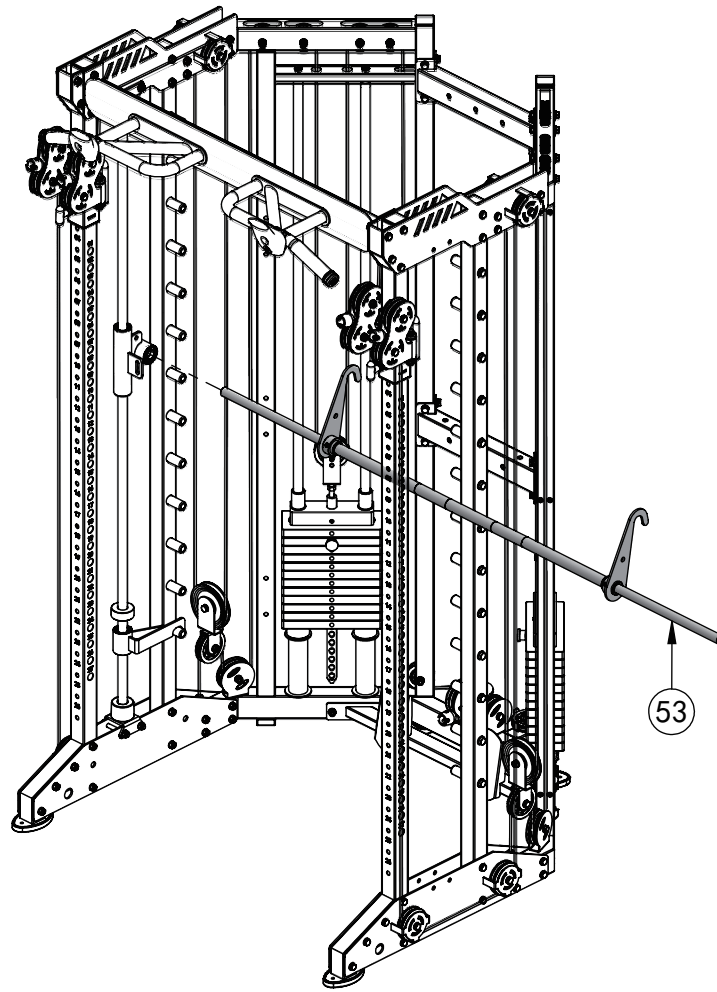

NO.	DESCRIPTION	NOTE	QTY
53	Barbell Bar	Assembly Part	1

ASSEMBLY STEP 12

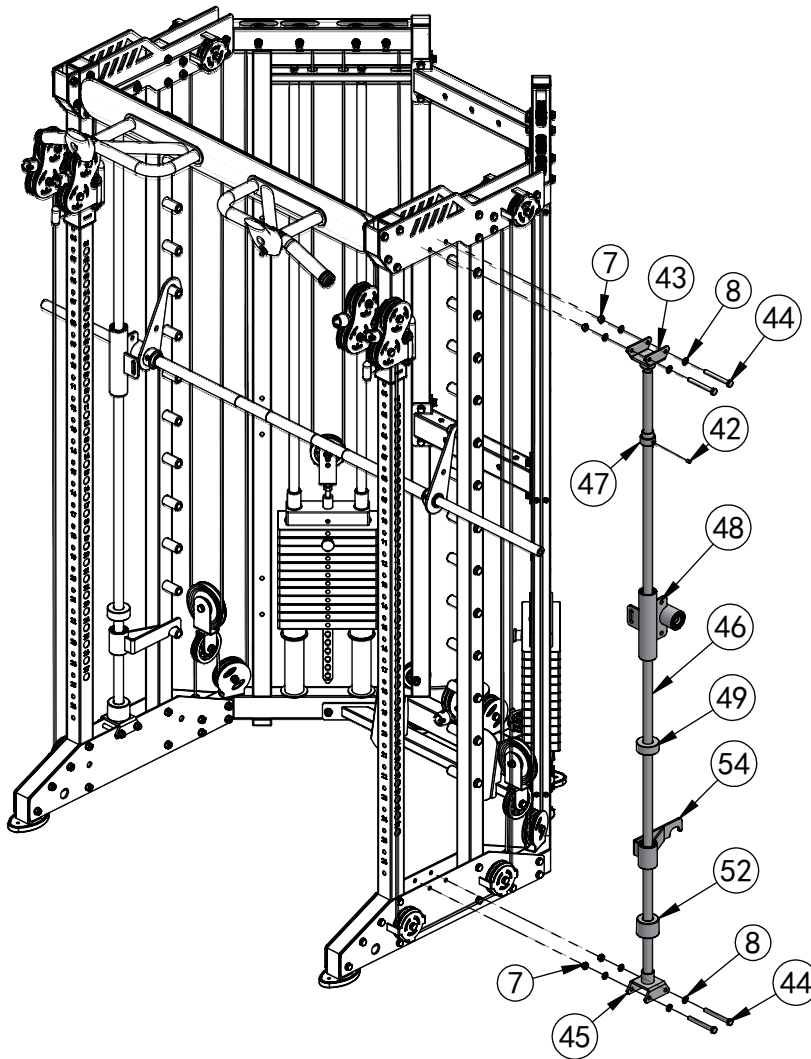

NO.	DESCRIPTION	NOTE	QTY
7	Lock Nut	M10	4
8	Flat Washer	φ10	8
42	Headless Hexagon Socket Bolt	M8*10	1
43	Guide Rod Upper Base	Welding Part	1
44	Hexagon Bolt	M10×90	4
45	Guide Rod Lower Base	Welding Part	1
46	Guide Rod	φ25*1878	1
47	Lock Sleeve	φ40*φ25.5*35	1
48	Sliding Sleeve	Assembly Part	1
49	Rubber Shock Pad	φ60×φ26×25	1
52	Rubber Shock Pad	φ60×φ26×45	1
54	Safety Hook Left	Assembly Part	1

ASSEMBLY STEP 13

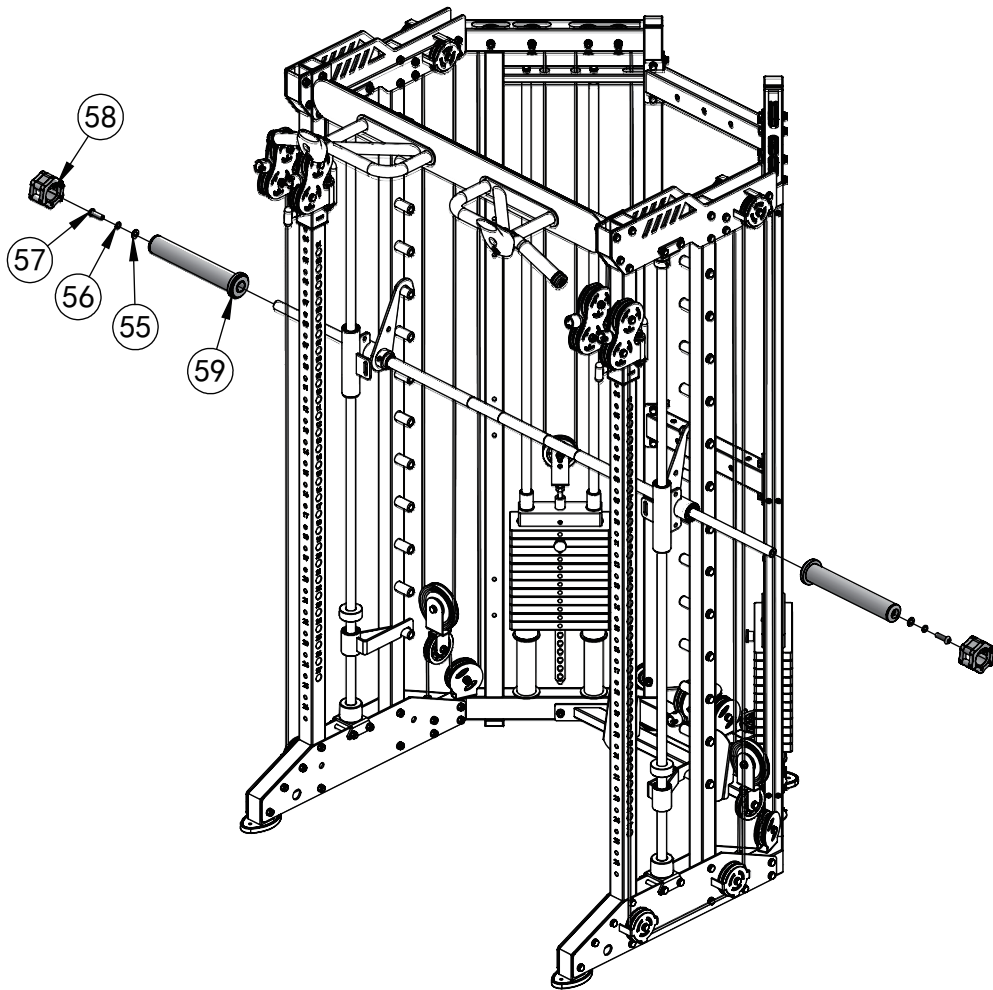

NO.	DESCRIPTION	NOTE	QTY
55	Flat Washer	φ12	2
56	Spring Gasket	φ12	2
57	Hexagon Socket Button Head Screw	M12×40	2
58	Barbell Clamp	Φ85XΦ50XH49	2
59	Barbell Bar Sleeve	Assembly Part	2

ASSEMBLY STEP 14

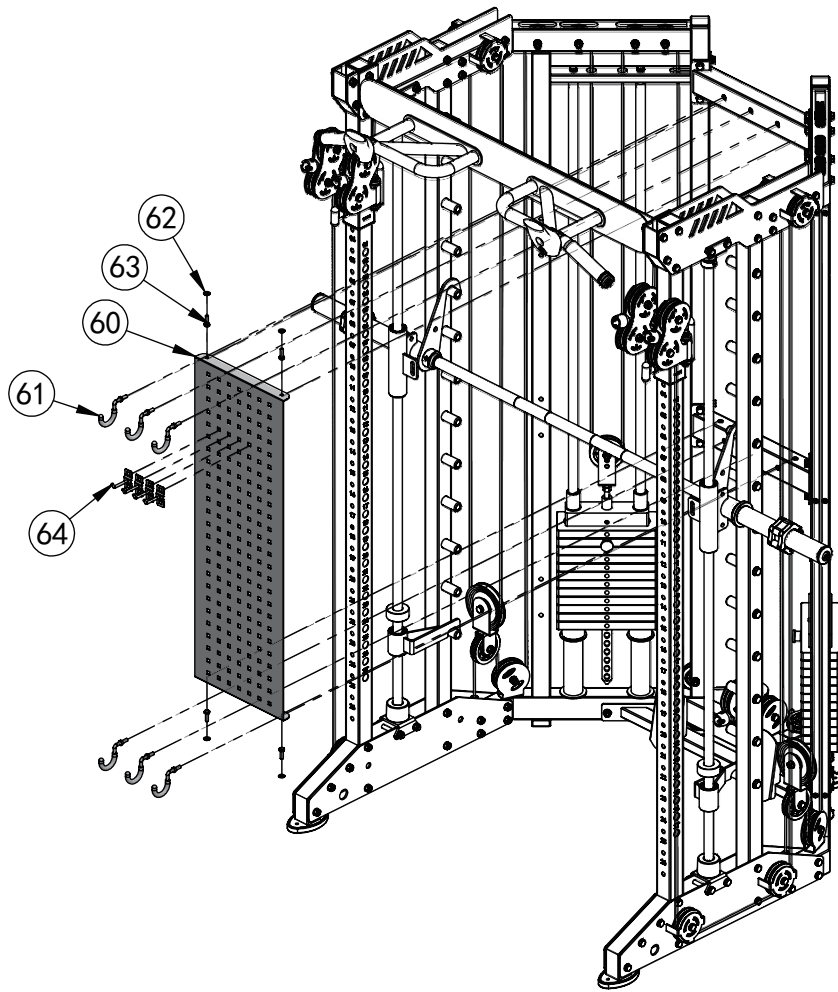

NO.	DESCRIPTION	NOTE	QTY
60	Shield	T2	1
61	Hook	Assembly Part	6
62	Flat Washer	$\phi 8$	4
63	Hexagon Bolt	M8×25	4
64	Hook	50mm	4

ASSEMBLY STEP 15

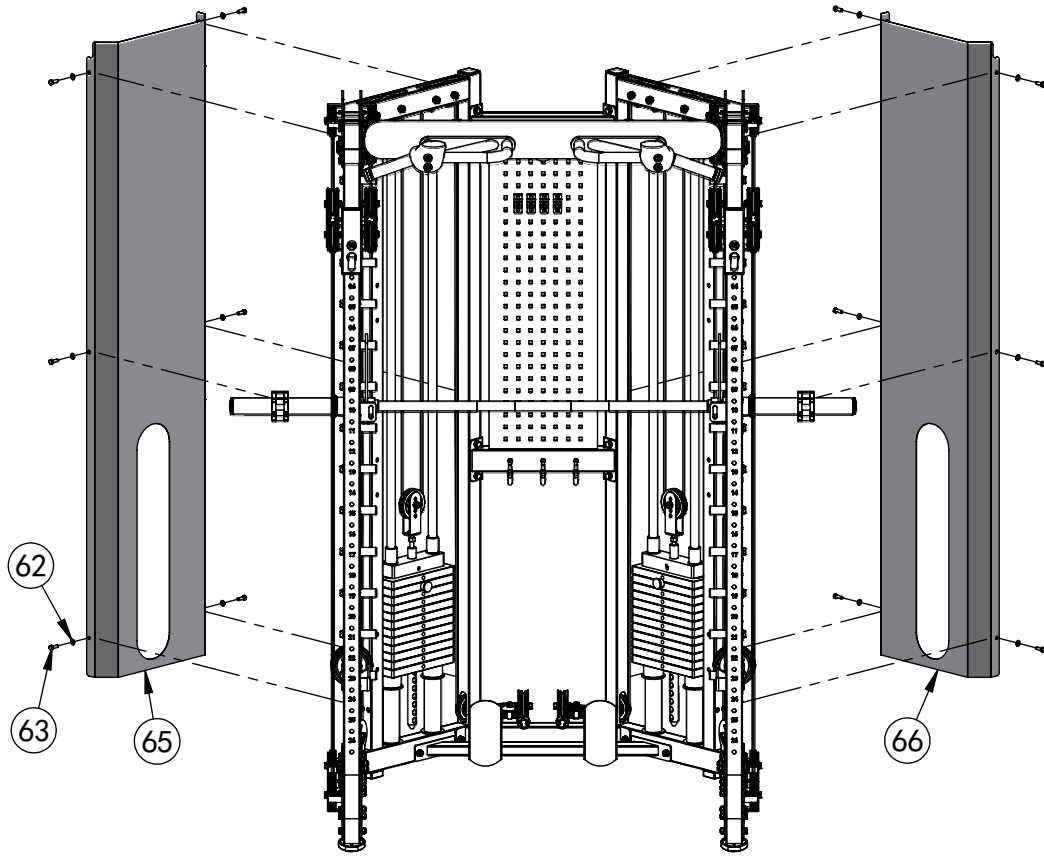

NO.	DESCRIPTION	NOTE	QTY
62	Flat Washer	φ8	12
63	Hexagon Bolt	M8×25	12
65	Weight Plate Cover Left	T1	1
66	Weight Plate Cover Right	T1	1

ASSEMBLY STEP 16

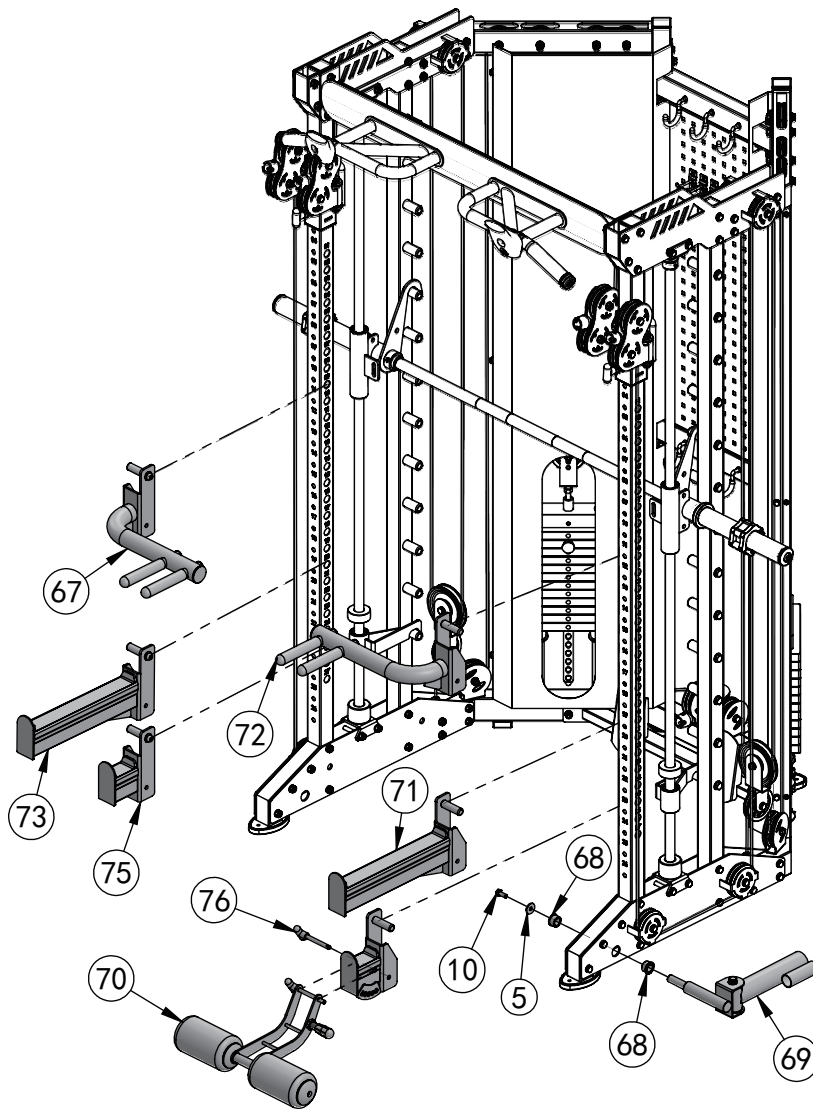

NO.	DESCRIPTION	NOTE	QTY
5	Big Flat Washer	$\phi 30 * \phi 10 * 3$	1
10	Hexagon Bolt	M10×25	1
67	Dip Handle Left	Assembly Part	1
68	Bushing	$\phi 33 \times \phi 29 \times \phi 20 \times 18$	2
69	Core Trainer	Assembly Part	1
70	Leg Press	Assembly Part	1
71	Safety Spotter Right	Assembly Part	1
72	Dip Handle Right	Assembly Part	1
73	Safety Spotter Left	Assembly Part	1
74	J Hook Right	Assembly Part	1
75	J Hook Left	Assembly Part	1
76	T-shaped Pin	$\phi 10 \times 85$	1
77	Lat Pull Down Bar	Assembly Part	1

Accessory

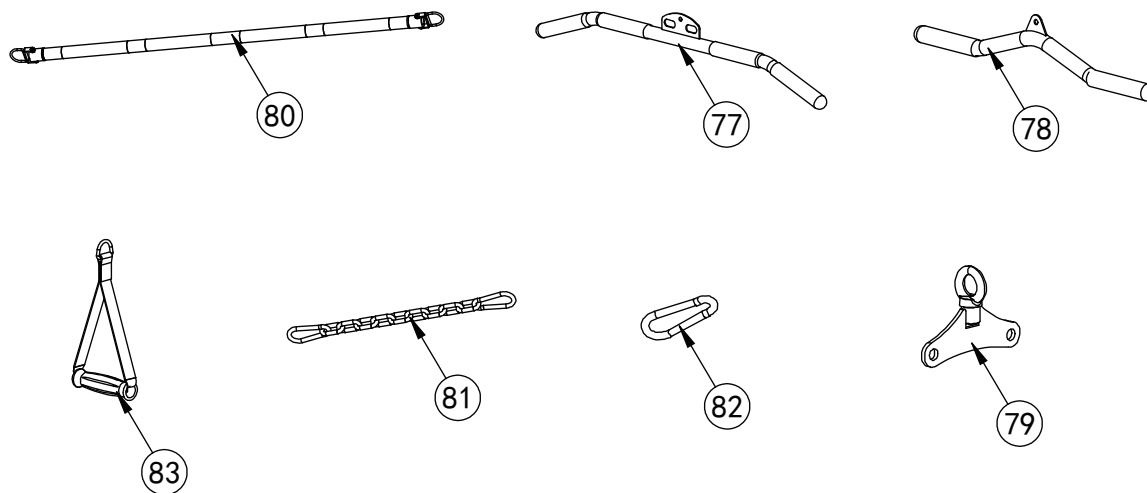

NO.	DESCRIPTION	NOTE	QTY
77	Lat Pull Down Bar	Assembly Part	1
78	Low Pull Handle	Assembly Part	1
79	Dual Cable Connector	Assembly Part	3
80	Straight Bar	Assembly Part	1
81	Extension Chain+	Assembly Part	2
82	Carabiner	Standard Part	5
83	Nylon Handle	Universal Part	2